



Venue operator



KINEXIN
Convention
Management



ORGANIZER'S GUIDE

www.iiccindia.com

Organizer's Guide Contents

IICC Organizer's Guide will help you easily understand facilities and services of IICC.
We promise to make your event a huge success with India's largest & newest facilities and quality service.



IICC INTRODUCTION

IICC LOCATION
IICC SITE MAP

EXHIBITION HALL

EXHIBITION HALL 1
EXHIBITION HALL 2

OUTDOOR EXHIBITION 1
OUTDOOR EXHIBITION 2

CONVENTION CENTRE

CONVENTION CENTRE B1
CONVENTION CENTRE GF
CONVENTION CENTRE F1
CONVENTION CENTRE F2
CONVENTION CENTRE F3
CONVENTION CENTRE F4
CONVENTION CENTRE F5
CONVENTION CENTRE F6
CONVENTION CENTRE F7

OTHER SERVICES

PARKING GUIDE
CATERING SERVICE
ACCOMODATION
TRANSPORTATION
TOURIST ATTRACTIONS

CONTACT

Yashobhoomi | INDIA
INTERNATIONAL
CONVENTION AND EXPO CENTRE



IICC INTRODUCTION

Yashobhoomi - IICC LOCATION

25 Dwarka, Dwarka, New Delhi, Delhi 110061, India



Complex will provide world-class facilities for national and international conferences exhibitions trade shows and cultural events, the site is close to major transport house a Sports Complex the proposed diplomatics and plays a golf course the aero city hotels and it is just 10km away from Delhi's International Airport. It is accessible via Dwarka expressway and the urban extension road will be connected to the Delhi Jaipur railway line, The Airport Express Metro and Dwarka metro lines will also be extended after the center of the complex with an estimated cost of 26,000 crore.

Yashobhoomi - **IICC**
INDIA INTERNATIONAL CONVENTION AND EXPO CENTRE

Yashobhoomi

**INDIA
INTERNATIONAL
CONVENTION AND EXPO CENTRE**



EXHIBITION HALL

EXHIBITION HALL 1_FLOOR PLAN-GF

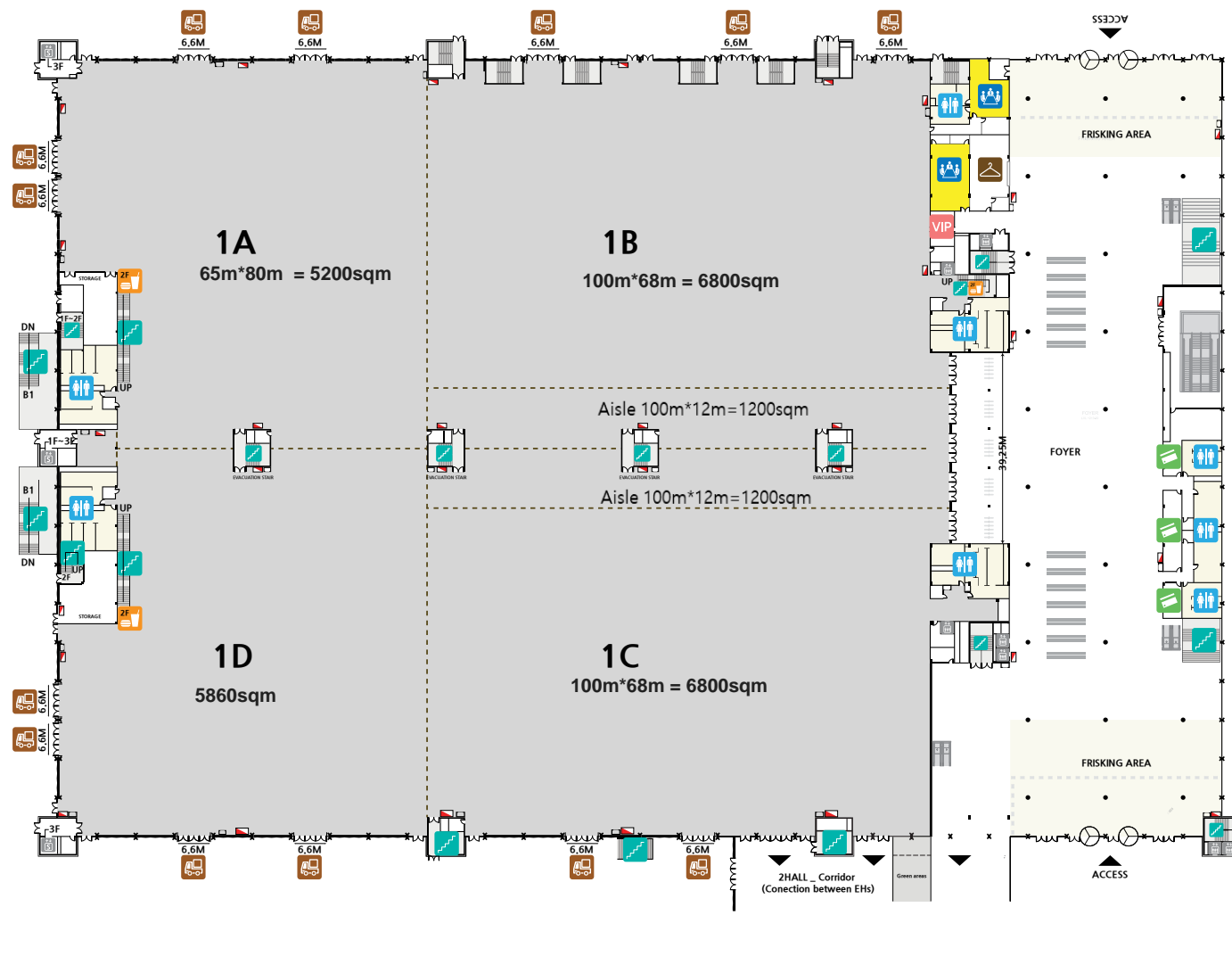

GENERAL INFORMATION

Scale

27000 Sqm / Total

Size Details

Ceiling Height : 15m

Capacity

up to 1,500 Booths (3x3m including aisles)

Utilities

Floor Trench : Electricity, Water/Drainage, Compressed Air, Telephone, Internet,

Facilities

Organizer`s Offices(2 rooms), VIP Room, Media Room etc.

GF Organizer's Offices : $7.99(W) \times 11.85(L)m = 94.68 \text{sqm} / 1EA$

GF Organizer's Offices : $8(W) \times 13.725(L) m = 109.8 \text{ sqm} / 1EA$

GF_VIP Room : 4.8(W)x7.081(L)m=33.98sqm / 1EA

* The first floor of the exhibition hall and the first floor of the convention center have a connecting bridge.

ICON INDEX

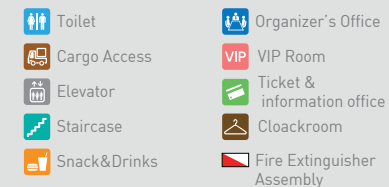

KEY MAP

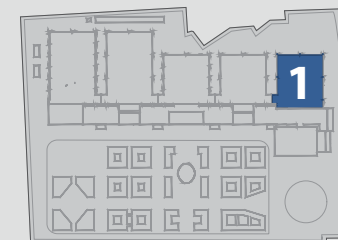

EXHIBITION HALL 2_FLOOR PLAN-GF

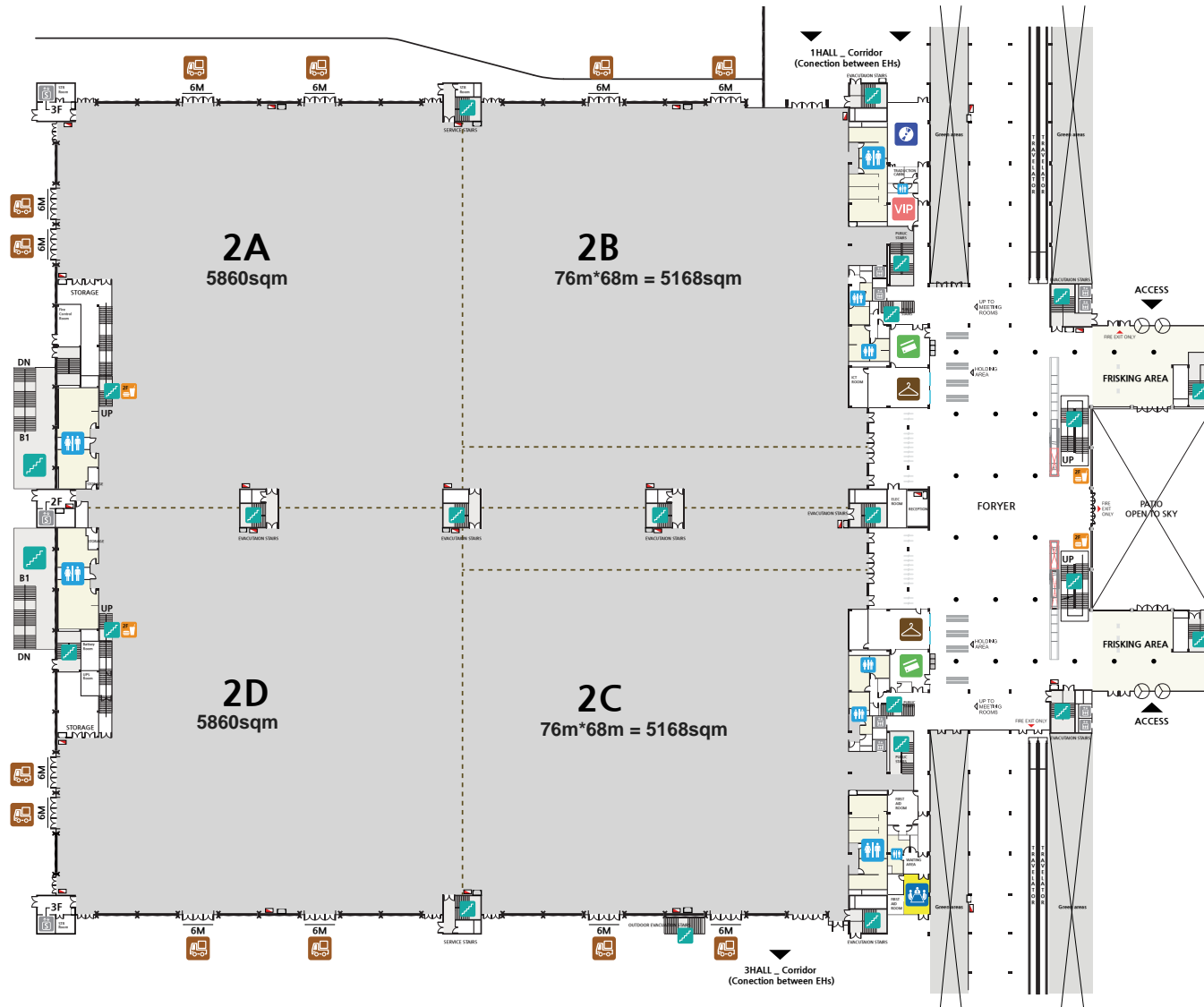

GENERAL INFORMATION

Scale

24000 sqm / Total

Size Details

Ceiling Height : 15m

Capacity

up to 1,300 Booths (3x3m inclding aisles)

Utilities

Floor Trench : Electricity, Water/Drainage, Compressed Air, Telephone, Internet,

Facilities

Organizer's Offices, VIP Room, Media Room, Ticket & Information Office etc.

GF_VIP Room : 5.94(W)x6.39(L)m=37.95sqm / 1EA

GF_Organizer's Offices : 5.15(W)x7.895(L)m=40.65sqm / 1EA

* The first floor of the exhibition hall and the first floor of the convention center have a connecting bridge.

ICON INDEX

- | | |
|--------------|-----------------------------|
| Toilet | Organizer's Office |
| Cargo Access | VIP Room |
| Elevator | Media Room |
| Staircase | Ticket & information office |
| Snack&Drinks | Cloackroom |
| | Fire Extinguisher Assembly |

KEY MAP



Yashobhoomi

INDIA
INTERNATIONAL
CONVENTION AND EXPO CENTRE



CONVENTION CENTRE

CONVENTION CENTRE

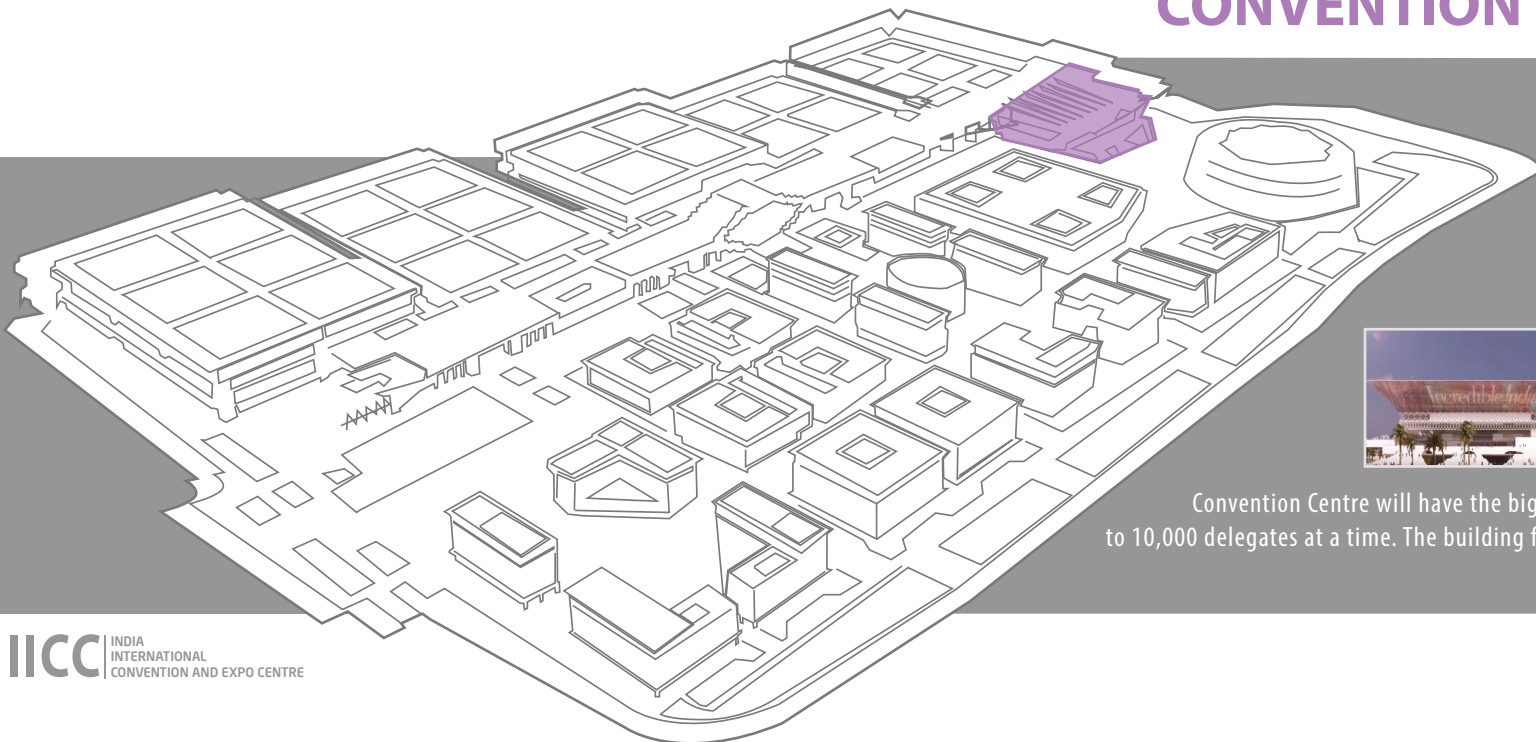

Convention Centre will have the biggest auditorium in the country with a capacity to post up to 10,000 delegates at a time. The building features a connection of flexible spaces and cover terraces. It will house the plenary hall that can seat 6,000 people

IICC INDIA
INTERNATIONAL
CONVENTION AND EXPO CENTRE

B1

GENERAL INFORMATION

Scale_Conference Room B101-B102

Conference Room B101 A: 623.98sqm

Conference Room B102 B: 623.98sqm

Conference Room B101-B102

Conference Room B101 A: 21.61x19.74m

Conference Room B102 B: 21.61x19.74m

Ceiling Height: 9.97m

Capacity (Theatre Type)

Conference Room B101 A: 535 seats

Conference Room B102 B: 535 seats

GF-1F

GENERAL INFORMATION

Scale_Auditorium(B1-F2)

4,066.98 sqm / Total

Size Details_Auditorium(B1-F2)

Width x Length: 78.25x46.80m

Ceiling Height: 22.5m

Capacity (Theatre Type)

6,051 seats / Total(B1-F2)

2F

GENERAL INFORMATION

Scale_Conference Room 201 & 202

Conference Room 201: 327.93 sqm / Total

Conference Room 202: 215.51 sqm / Total

Conference Room 201 & 202

Width x Length

Conference Room 201: 14.05x23.34m

Conference Room 202: 13.35x14.04m

Ceiling Height: 9.82m

Capacity (Theatre Type)

Conference Room 201: 282 seats

Conference Room 202: 184 seats

3F

GENERAL INFORMATION

Scale_Conference Room 301-305

Conference Room 301: 222.58 sqm / Total

Conference Room 302: 312.27 sqm / Total

Conference Room 303: 182.04 sqm / Total

Conference Room 304: 298.04 sqm / Total

Conference Room 305: 322.71 sqm / Total

Conference Room 301-305

Width x Length

Conference Room 301: 11.27x19.75m

Conference Room 302: 15.71x19.75m

Conference Room 303: 11.58x14.03m

Conference Room 304: 15.19x19.16m

Conference Room 305: 16.34x19.75m

Ceiling Height: 9.97m

Capacity (Theatre Type)

Conference Room 301: 191 seats

Conference Room 302: 260 seats

Conference Room 303: 139 seats

Conference Room 304: 250 seats

Conference Room 305: 277 seats

4F

GENERAL INFORMATION

Scale_Conference Room 401-405

Conference Room 401: 148.04 sqm / Total

Conference Room 402: 150.04 sqm / Total

Conference Room 403: 134.43 sqm / Total

Conference Room 404 A: 177.84 sqm / Total

Conference Room 405: 177.84 sqm / Total

Conference Room 401-405

Width x Length

Conference Room 401: 12.74x11.62m

Conference Room 402: 12.89x11.64m

Conference Room 403: 11.49x11.7m

Conference Room 404 A: 11.7x15.2m

Conference Room 405: 11.7x15.2m

Ceiling Height: 9.97m

Capacity (Theatre Type)

Conference Room 401: 127 seats

Conference Room 402: 129 seats

Conference Room 403: 115 seats

Conference Room 404 A: 151 seats

Conference Room 405: 151 seats

5F

GENERAL INFORMATION

OFFICE AREA / Total:1,467.2 sqm

1. 38.9m X 28.6m = 111.2sqm

2. 22.2m X 15.6m = 345.7sqm

KITCHEN AREA_Total: 838.6 sqm

1. 44m X 12.2m = 536.8sqm

2. 36.8m X 8.2m = 301.8sqm

LOUNGE AREA_Total: 600 sqm

42.9m X 14m = 600sqm

Capacity (Theatre Type)

83 seats

6F

GENERAL INFORMATION

Scale_Grand Ballroom (6F-7F)

3,466.90 sqm / Total

Size Details_Grand Ballroom (6F-7F)

Width x Length: 83.82x41.96m

Ceiling Height: 10m

Capacity (Theatre Type)

2,924 seats

CONVENTION CENTRE_B1

GENERAL INFORMATION

Scale_Conference Room B101 A & B - Amaltas Hall 1200 Sqm

Conference Room B101 A : 600 sq.m
Conference Room B101 B : 600sq.m

Size Details_Conference B101 A & B

Conference Room B101 A : 31.61x19.74m
Conference Room B101 B : 31.61x19.74m
Ceiling Height : 8 m

Capacity (Theatre Type)

Conference Room B101 A : 500 seats
Conference Room B101 B : 500 seats

Screen Facility

Conference Room B101 A :
400" (16:10) Screen + 30000Ansi(1920x1200) Laser Projector
Conference Room B101 B :
464" (16:10) Screen + 30,000Ansi (2K) DLP Projector
400" (16:10) Screen + 30000Ansi (1920x1200) Laser Projector

* The first floor of the exhibition hall and the first floor of the convention center have a connecting bridge.

ICON INDEX

- | | | | |
|--|----------------------|--|----------------------------|
| | Toilet | | Kitchen |
| | Toilet | | AHU |
| | VIP Elevator | | Technical Room AHU |
| | FIRE Elevator | | Control Room |
| | Loading Elevator | | Electrical Room |
| | Elevator | | Storage |
| | Parking Elevator | | Pantry |
| | Staircase | | VIP Lounge |
| | Emergency Room | | Fire Extinguisher Assembly |
| | Information & Ticket | | |
| | Prayer Room | | |

KEY MAP

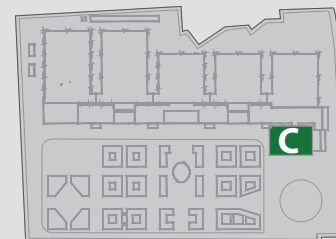

CONVENTION CENTRE_GF

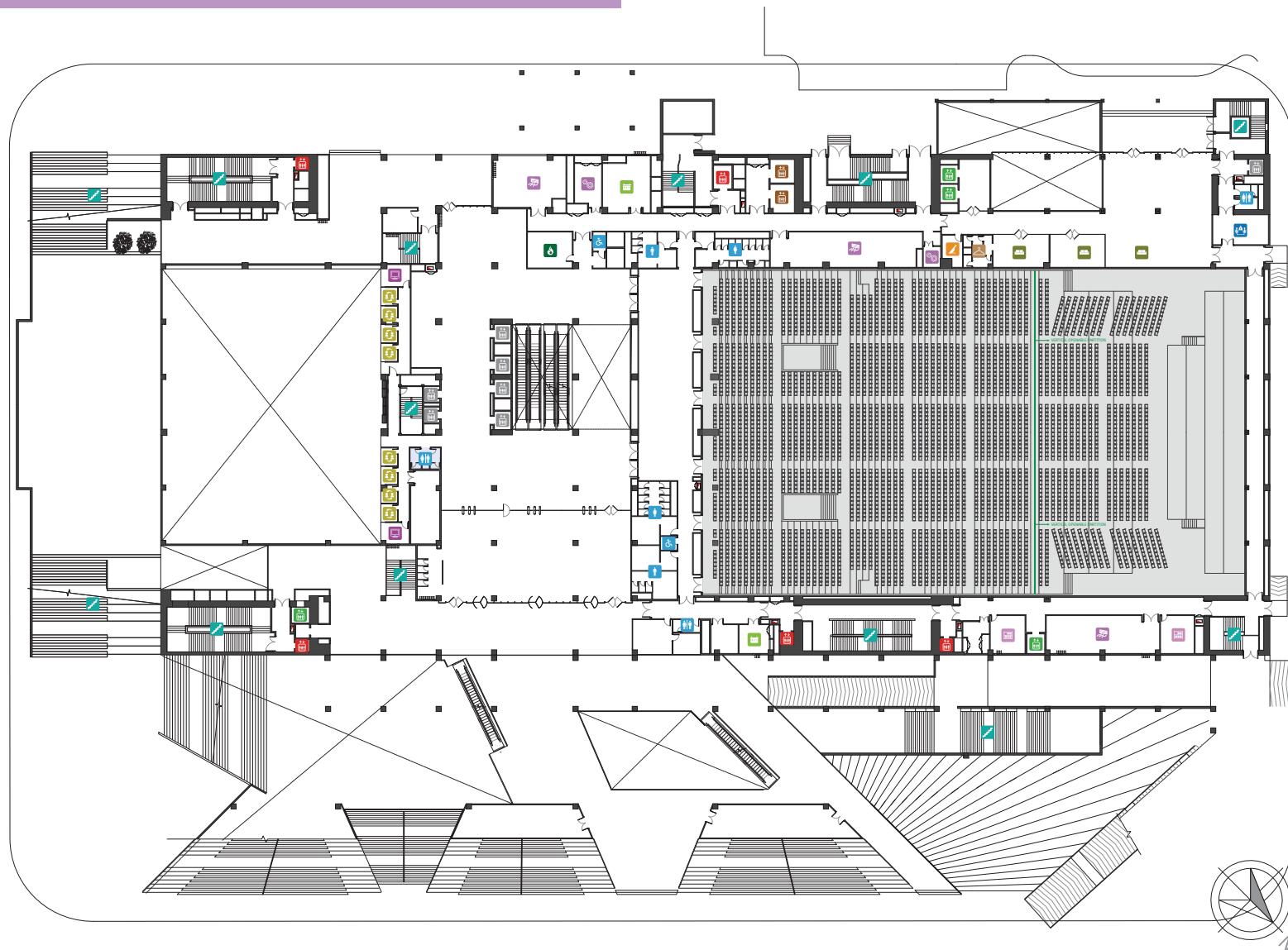

GENERAL INFORMATION

Scale_Auditorium(B1~F2)

4,066.98 sq.m / Total

Size Details_Auditorium(B1~F2)

Width x Length : 78.25x46.80m
Ceiling Height : 22.5m

Capacity

6,051 seats / Total(B1~F2)

* The first floor of the exhibition hall and the first floor of the convention center have a connecting bridge.

ICON INDEX

	Toilet		AHU
	Toilet		Technical Room AHU
	VIP Elevator		Control Room
	FIRE Elevator		Interpreter Room
	Loading Elevator		Electrical Room
	Elevator		Powder Room
	Staircase		Kitchen
	Lounge		Fire Command Center
	Storage		Fire Extinguisher Assembly

KEY MAP

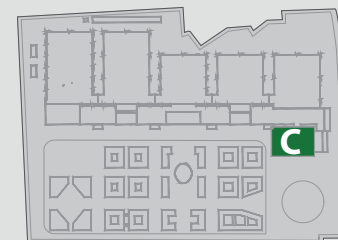

CONVENTION CENTRE_1F

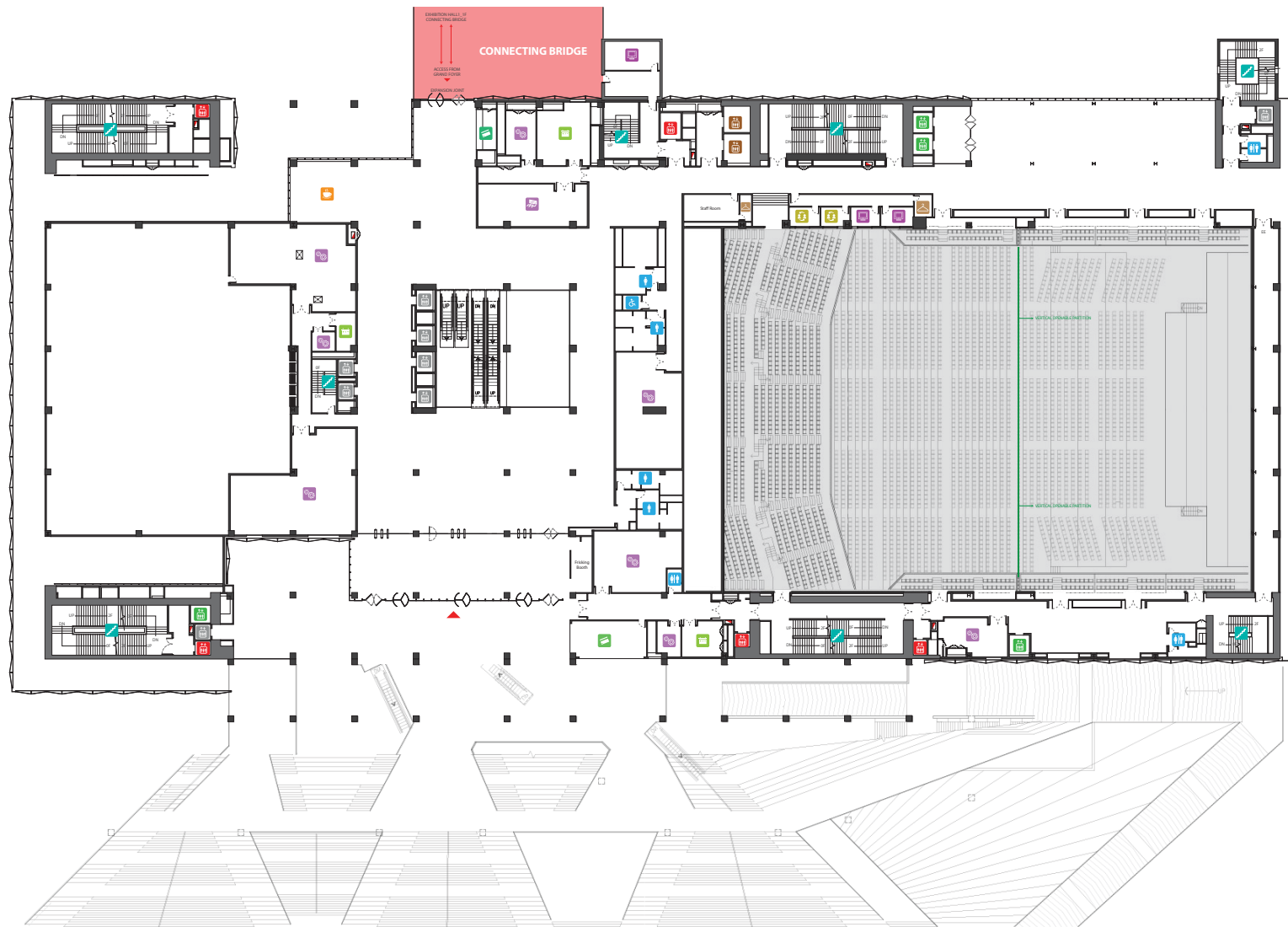

GENERAL INFORMATION

Scale_Auditorium(B1~F2)

4,066.98 sq.m / Total

Size Details_Auditorium(B1~F2)

Width x Length : 78.25x46.80m
Ceiling Height : 22.5m

Capacity

6,051 seats / Total(B1~F2)

* The first floor of the exhibition hall and the first floor of the convention center have a connecting bridge.

ICON INDEX

	Toilet		AHU
	Toilet		Technical Room AHU
	VIP Elevator		Control Room
	FIRE Elevator		Interpreter Room
	Loading Elevator		Electrical Room
	Elevator		Powder Room
	Staircase		Cafe
	Reception		Fire Extinguisher Assembly
	Ticket & information office		

KEY MAP

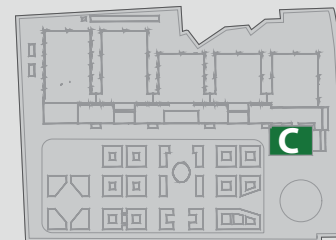

CONVENTION CENTRE_2F

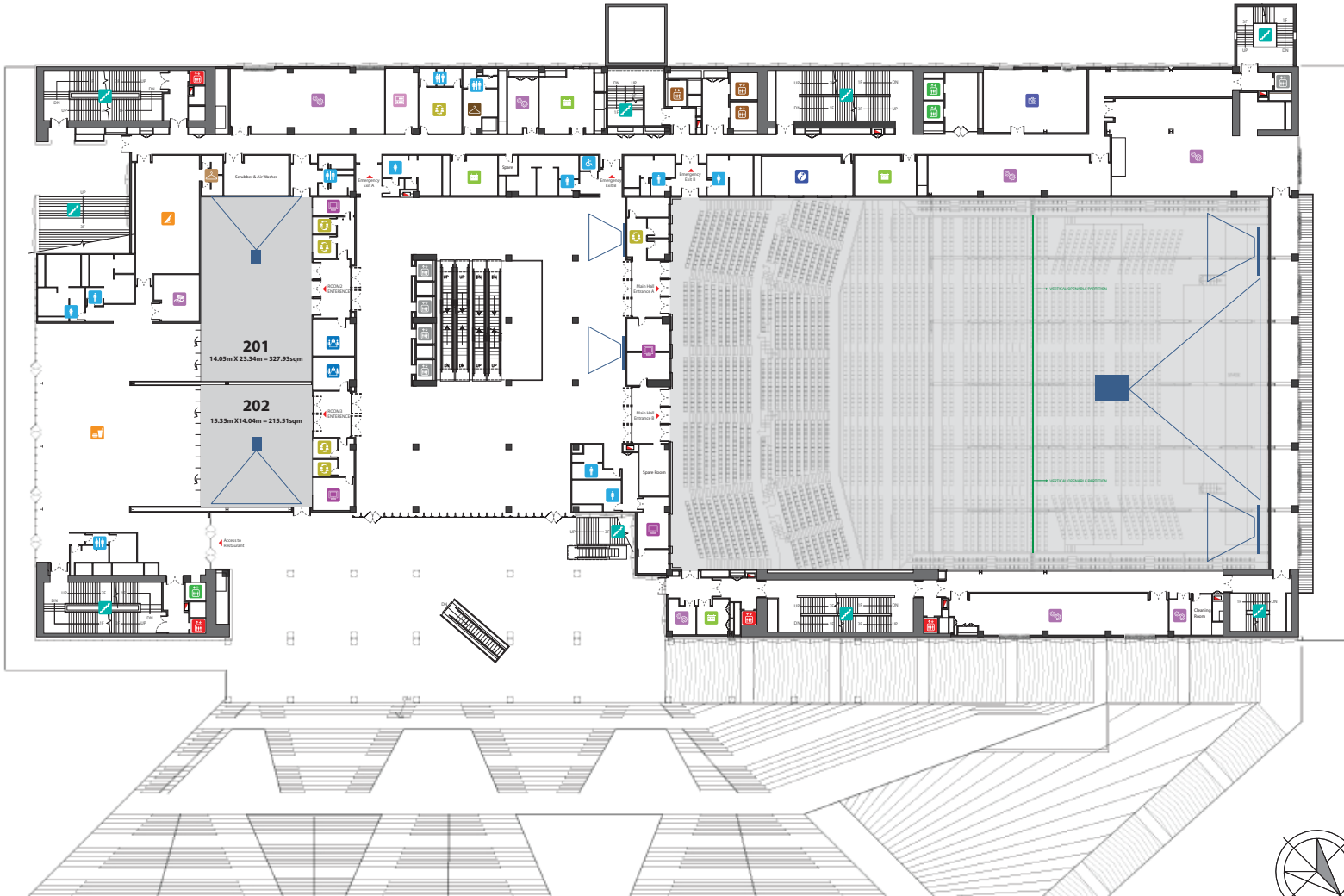

GENERAL INFORMATION

Scale_Conference Room 201 & 202

Conference Room 201 : 316 sq.m / Total
Conference Room 202 : 205.sq.m / Total

Size_Details_Conference Room 201 & 202

· Width x Length
Conference Room 201 : 14.05x23.34m
Conference Room 202 : 15.35x14.04m
· Ceiling Height : 3.82m

Capacity (Theatre Type)

Conference Room 201 : 272 seats
Conference Room 202 : 176 seats

Screen Facility

Conference Room 201 :
180" (16:10) Screen + 8,000Ansi(1920x1200) DLP Projector
Conference Room 202 :
180" (16:10) Screen + 8,000Ansi(1920x1200) DLP Projector

* The first floor of the exhibition hall and the first floor of the convention center have a connecting bridge.

ICON INDEX

	Toilet		Powder Room
	Toilet		AHU
	VIP Elevator		Technical Room AHU
	FIRE Elevator		Control Room
	Loading Elevator		Interpreter Room
	Elevator		Electrical Room
	Staircase		Waiting Room
	Restaurant		TV Station Room
	Kitchen		Pressurisation Room
	Staff Locker		Fire Extinguisher Assembly

KEY MAP

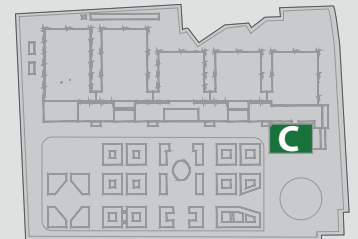

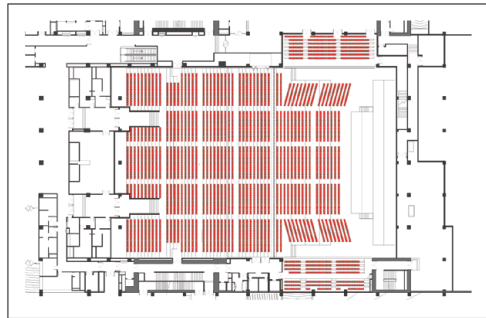
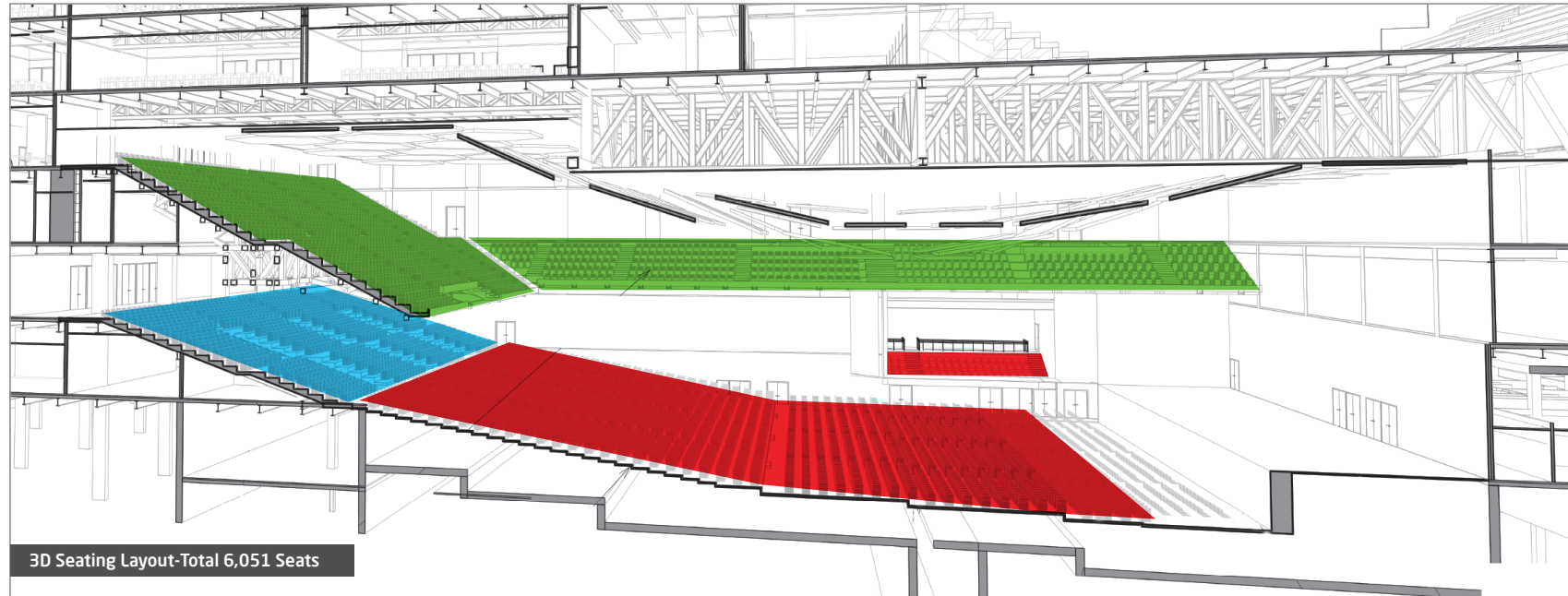

Basement 1 Level -4.65m
3,839 Seats

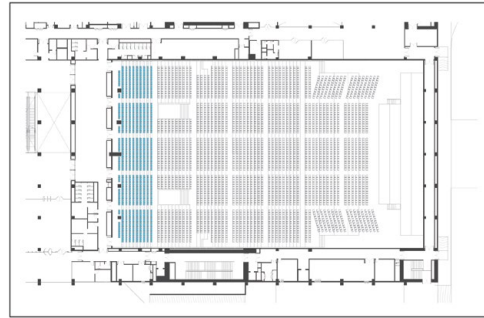

Ground floor Level (0,00)
662 Seats

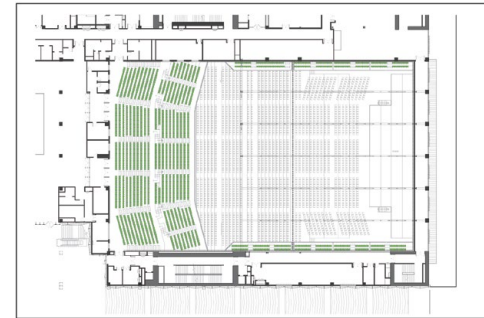

Second Floor Level (+9.30)
1,550 Seats

Screen Facility

552" (16:10) Screen + 30,000Ans(1920x1200) DLP Projector
464" (16:10) Screen + 30,000Ans(2K 4K)DLP Projector
150" (16:10)Screen + 5,000Ans(1920x1200) DLP Projector
98" LED Display / Under Balcony and Green Room, Rehearsal, Waiting, VIP Waiting Lounge Area

CONVENTION CENTRE_3F



GENERAL INFORMATION

Scale_Conference Room 301~305

Conference Room 301 : 222.58 sq.m / Total
Conference Room 302 : 310.27 sq.m / Total
Conference Room 303 : 162.04 sq.m / Total
Conference Room 304 : 291.04 sq.m / Total
Conference Room 305 : 322.71 sq.m / Total

Size Details_Conference Room 301~305

· Width x Length
Conference Room 301 : 11.27x19x75m
Conference Room 302 : 15.71x19.75m
Conference Room 303 : 11.55x14.03m
Conference Room 304 : 15.19x19.16m
Conference Room 305 : 16.34x19.75m
· Ceiling Height : 3.97m

Capacity (Theatre Type)

Conference Room 301 : 182 seats
Conference Room 302 : 252 seats
Conference Room 303 : 124 seats
Conference Room 304 : 250 seats
Conference Room 305 : 269 seats

Screen Facility

Conference Room 301,302,304,305 :
180" (16:10) Screen + 8,000Ans(1920x1200) DLP Projector
Conference Room 303 :
150" (16:10) Screen + 6,000Ans(1920x1200) DLP Projector

ICON INDEX

	Toilet		Staff Locker
	Toilet		Powder Room
	VIP Elevator		Technical Room AHU
	FIRE Elevator		Control Room
	Loading Elevator		Interpreter Room
	Elevator		Electrical Room
	Staircase		Waiting Room
	Kitchen		Lounge
	Storage		Fire Extinguisher Assembly

KEY MAP

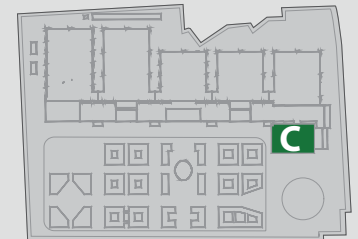

CONVENTION CENTRE_4F



GENERAL INFORMATION

Scale_Conference Room 401~406

Conference Room 401 : 148.04 sq.m / Total
Conference Room 402 : 150.04 sq.m / Total
Conference Room 403 : 134.43 sq.m / Total
Conference Room 404 A, 404B : 177.84 sq.m / Total
Conference Room 405 : 96.74 sq.m / Total

Size Details_Conference Room 401~405

· Width x Length · Ceiling Height : 3.97m
Conference Room 401 : 12.74x11.62m
Conference Room 402 : 12.89x11.64m
Conference Room 403 : 11.49x11.7m
Conference Room 404 A, 404B : 11.7x15.2m
Conference Room 405 : 8.29x11.67m

Capacity (Theatre Type)

Conference Room 401 : 127 seats
Conference Room 402 : 129 seats
Conference Room 403 : 115 seats
Conference Room 404 A, 404B : 153 seats
Conference Room 405 : 83 seats

Screen Facility

Conference Room 401, 402 :
150" (16:10) Screen + 6,000Ansi(1920x1200) DLP Projector
Conference Room 403, 405 :
130" (16:10) Screen + 6,000Ansi(1920x1200) DLP Projector
Conference Room 404AB :
355" (16:10) Screen + 13,000Ansi(1920x1200) DLP Projector

ICON INDEX

	Toilet		AHU
	VIP Elevator		Technical Room AHU
	FIRE Elevator		Control Room
	Loading Elevator		Interpreter Room
	Elevator		Electrical Room
	Staircase		Electrical Low Voltage Room
	Staff Locker		Waiting Room
	Powder Room		VIP Room
	Storage		Fire Extinguisher Assembly

KEY MAP

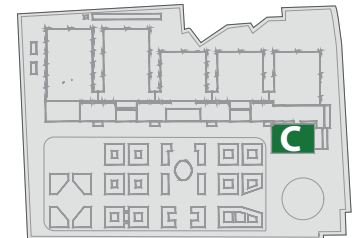

CONVENTION CENTRE_5F



GENERAL INFORMATION

OFFICE AREA / Total: 1467.2 sqm

1. 38.9m X 28.6m = 1112.3sqm
2. 22.2m X 16m = 355.25sqm

KITCHEN AREA_Total : 838.6 sqm

1. 44m X 12.2m = 536.8sqm
2. 36.8m X 8.2m = 301.8sqm

LOUNGE AREA_Total : 600 sqm

42.9m X 14m = 600sqm

* The first floor of the exhibition hall and the first floor of the convention center have a connecting bridge.

ICON INDEX

- | | |
|----------------------|----------------------------|
| Toilet | AHU |
| WIP Elevator | Technical Room AHU |
| FIRE Elevator | ICT Technical Room |
| Loading Elevator | Operation Control Room |
| Elevator | Electrical Room |
| Staircase | Kitchen |
| Staff Locker | Scrub Room |
| Lounge | Cylinder Room |
| Cafe | Main Data Center |
| Storage | Fire Extinguisher Assembly |
| Waiting Area | Meeting Room |
| Office Reception | Physically Handicap Booth |
| GM Management Office | Copy Center |
| Management Office | |

KEY MAP

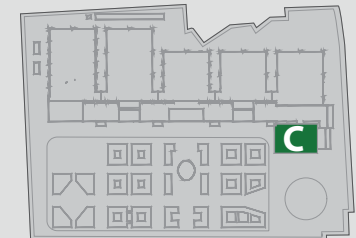

CONVENTION CENTRE_6F

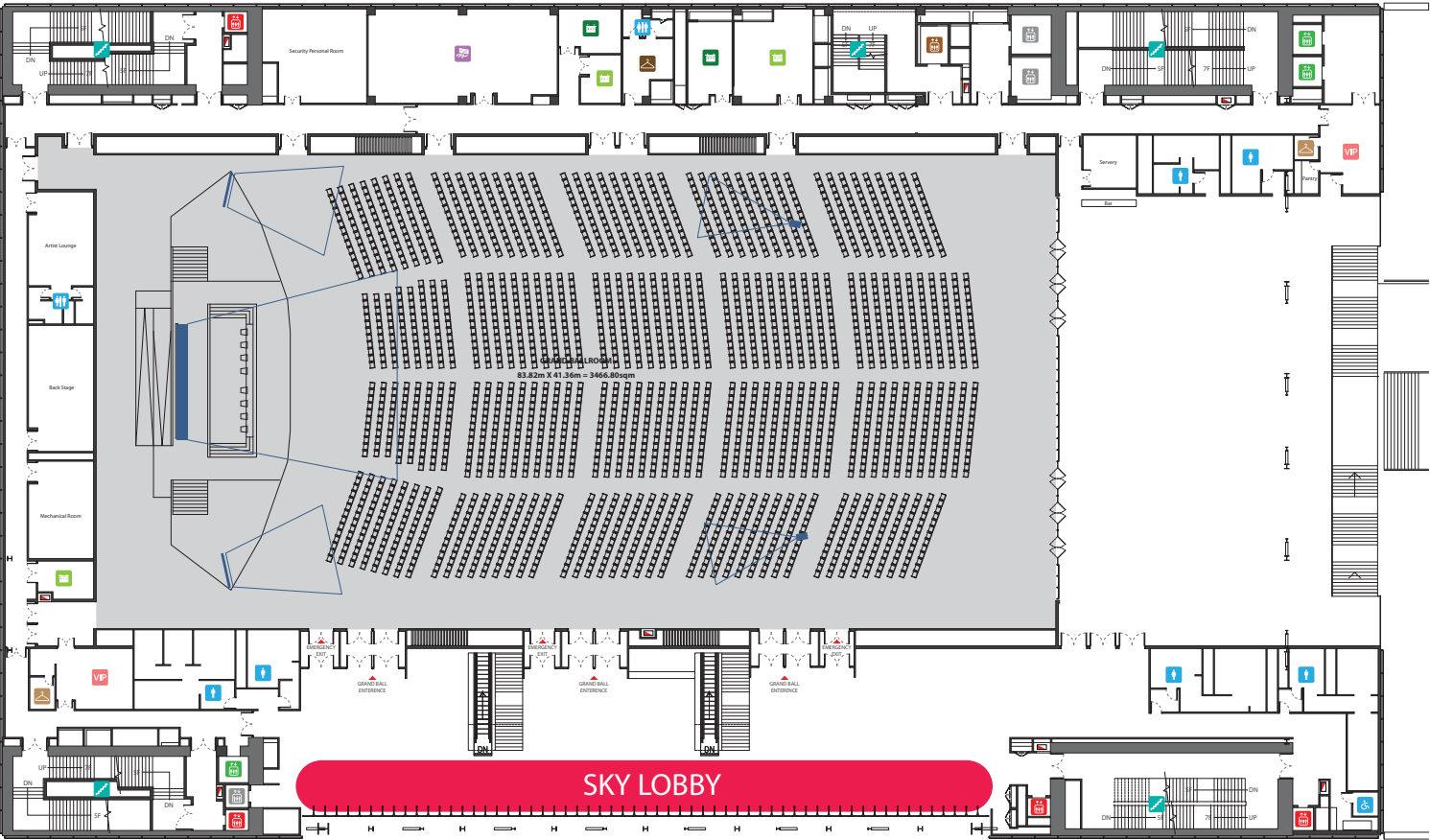

GENERAL INFORMATION

Scale_Grand Ballroom (6F~7F)

3,466.80 sq.m / Total

Size_Details_Grand Ballroom (6F~7F)

Width x Length : 83.82x41.36m
Ceiling Height: 8m

Capacity (Theatre Type)

2,500 seats

Screen Facility

10x6.25M LED Video Wall Display
370" (16:10) Screen + 30,000Ansi(1920x1200) DLP Projector

* The first floor of the exhibition hall and the first floor of the convention center have a connecting bridge.

ICON INDEX

- | | | | |
|--|------------------|--|-----------------------------|
| | Toilet | | Staff Locker |
| | Toilet | | Powder Room |
| | WIP Elevator | | AHU |
| | FIRE Elevator | | Electrical Room |
| | Loading Elevator | | Electrical Low Voltage Room |
| | Elevator | | Waiting Room |
| | Staircase | | VIP Room |
| | | | Fire Extinguisher Assembly |

KEY MAP

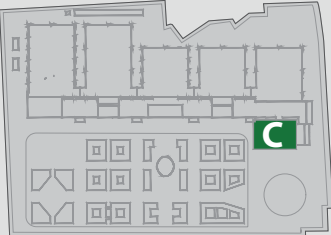

CONVENTION CENTER_SIDE ELEVATION

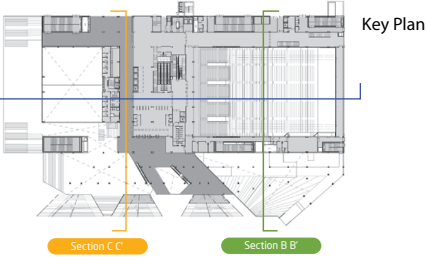

GENERAL INFORMATION

Facilities

- AUDITORIUM : B2~2F (6,051seats)
- GRAND BALLROOM : 6F (3,466sqm)
- CONFERENCE ROOMS : B1~4F (3,987sqm)

* The first floor of the exhibition hall and the first floor of the convention center have a connecting bridge.

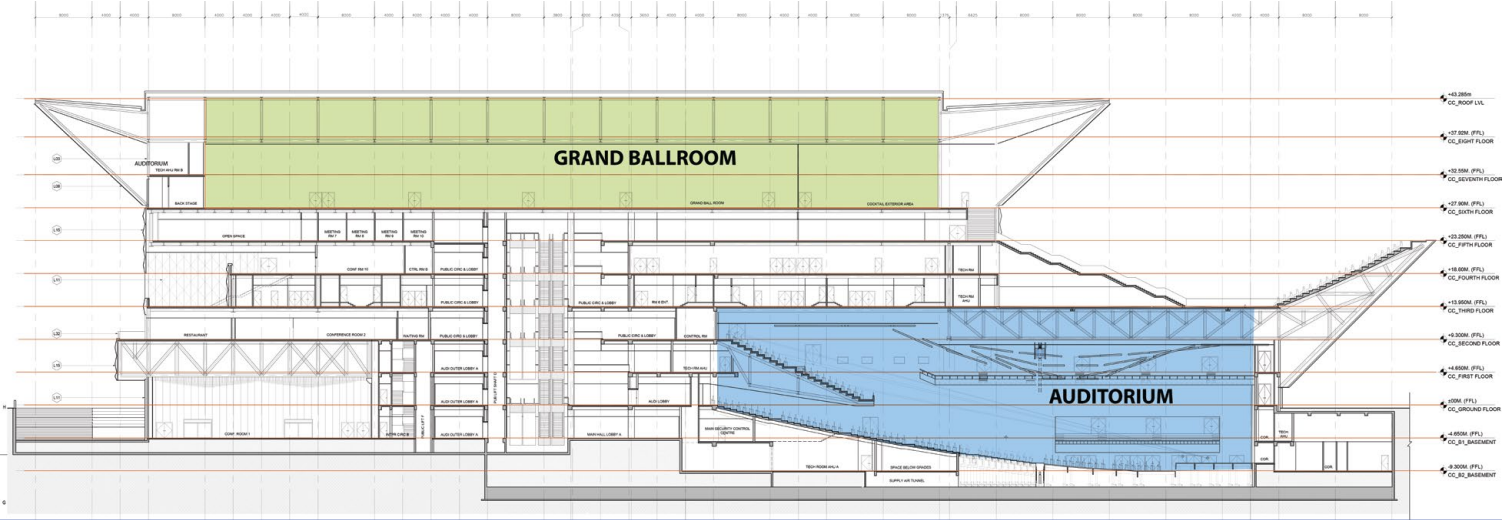

Section A A'

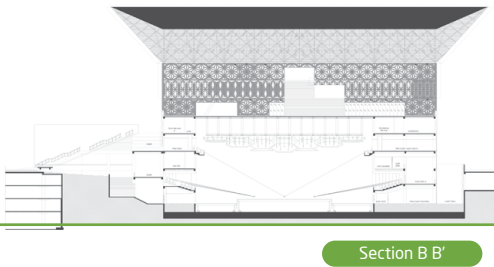

Section B B'

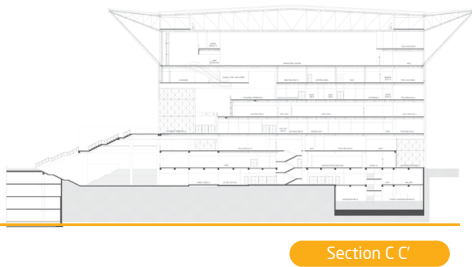

Section C C'

KEY MAP

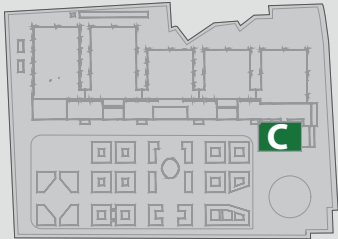

Attraction Guide Near IICC, Dwarka





Key Points of Aerocity

IICC Convention & Exhibition Centre



The biggest advantage of Aerocity is an excellent connectivity from and to all parts of India. Visitors can easily access from Dwarka, Gurgaon and South Delhi through Metro and National Highway 8.

Further, with its superb access to IGI Airport, Aerocity is a hub for International Business travellers and stop-over or transit tourists wishing to visit Delhi.



Aerocity is well known for the area where 17 deluxe hotels are densely located with more than 3,600 rooms. Further, since each 5 star hotel has their own signature finest restaurants, cafes and Bar Lounges, customer can enjoy multi – national cuisine in Aerocity.



Since there are many International business travellers and tourists, there is a lot of finest restaurants that provide various options for diners. Visitors can enjoy multi-national cuisine as well as authentic Indian cuisine in Aerocity.



- Aerocity Central (Shopping Mall)
- International Banking
- International remittance/ wire transfer
- ATM



Key Points of Cyber Hub

IICC Convention & Exhibition Centre



The biggest advantage of Cyber Hub which is located in Gurgaon is an easy access from and to all parts of India. Cyber Hub can be conveniently reached via various Metro stations (Indusind Bank Cyber City, Belvedere Tower, Phase 3, Moulisari Avenue) and the roads are well connected for an easy access. 24/7 parking lots are also available.



One of the must-go destination as Cyber Hub is shopping center. Since global franchise brands such as M&S, Uniqlo, Disney as well as Indian brands are operating under one roof of Cyber Hub, it becomes an iconic place for visitors.



There is a wide selection of multi – national cuisines in Cyber Hub that visitors can choose from. Each restaurant and café offers different cuisine and unique taste, there are diverse options for dine-outs.



Cyber Hub has SMAAASH which is one of India's most acclaimed gaming and entertainment center. It is renowned in the field of sports simulation technology and gamification technologies such as twilight bowling zone, motor racing and bike racing simulators and the go-karting tracks as well as AR and VR. Further, visitors can enjoy games while consuming liquors and enjoying delicious foods.

Historical Site

IICC Convention & Exhibition Centre



Humayun's Tomb – 25.7 km from IICC

Early representative works of Mughal architecture based on Persian style, is located near the Yamuna River.

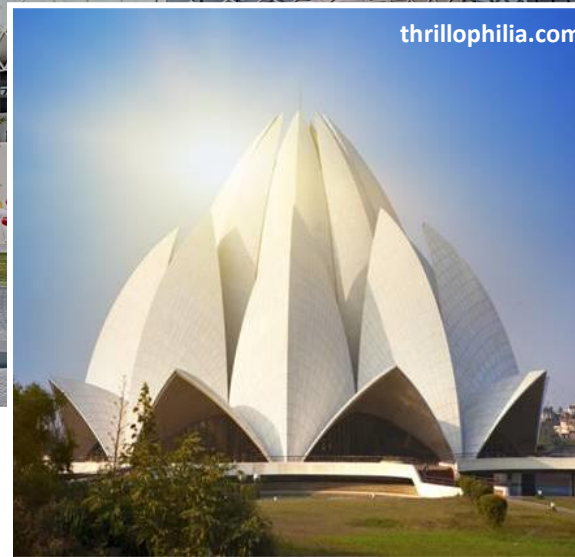

Lotus Temple- 26.1 km from IICC

Lotus temple of the Bahai Bridge located in Delhi, is known as one of the most beautiful buildings in the world.



Qutub Minar – 18.3 km from IICC

India's largest minar is designated as a UNESCO World Heritage Site. It is considered as the most prominent work in the Hindu and Islamic style.

Historical Site

IICC Convention & Exhibition Centre



Red Fort- 29.7 km from IICC

The magnificent complex, named the Red Fortress because of its warm red sandstone wall, which looks as if it were burning in the sun, was built by Shah Jahan.



Swaminarayan

Akshardham New Delhi – 30km from IICC

Swaminarayan Akshardham at New Delhi is a Mandir – an abode of God, a Hindu house of worship, and a spiritual and cultural campus dedicated to devotion, learning and harmony.



India Gate – 23 km from IICC

A monument standing at the central junction of New Delhi, Protected by armed soldiers, it is a memorial tower built during the British colonial period to honor the souls of Indian soldiers who fought in World War I.

Restaurant

IICC Convention & Exhibition Centre



Zomato

Spice Market - 23.9 km from IICC

Spice Market is modern Indian Bistro restaurant. The menu features a mix of modern Indian, pan-Indian and Delhi's staple shies many of them created by our own chef.



TripAdvisor

Kake Da Hotel - 23.9 km from IICC

It is popular local restaurant which has been runing almost 100 years since 1931. You can experience authentic Indian food.



Zamato/TripAdvisor

Dilli 32 – 35.1 km from IICC

It is local Indian restaurant with nice atomosphere. Main cuisine is North Indian such as dohara khumb, nukti kebab and arbi ki shammi.

Vegetarian Restaurant

IICC Convention & Exhibition Centre



Burma Burma - 12.1 km from IICC

Burma Burma is one of the most popular vegetarian restaurants which serve the Myanmar cuisine. It is the most optimal vegetarian restaurant where they provide fresh and organic food.



Veg Gulati – 25.6 km from IICC

Veg Gulati is the ultimate destination In Delhi for Vegetarian. The Restaurant is famous for it's north Indian Punjabi food and also for Jain & Sattvik food (without onion & garlic).



Devang House – 19.5 km from IICC

Devang House specializes in researching and offering integrative solutions for human health through Organic foods, Herbal supplements and Natural lifestyle products.

Cafe

IICC Convention & Exhibition Centre



TripAdvisor

Delhi Baking Company – 10.3 km from IICC

It only takes 20 minutes by car from IICC. You can have delicious dessert such as bread, panini, and salad in nice atmosphere.



TripAdvisor

Mister Chai – 23.4 km from IICC

This is a cafe in the Shangri-La's Erros Hotel. It's a place where you can experience delicious desserts and excellent service



Zamoto/TripAdvisor

Café Dori - 17.8 km from IICC

Abandoned warehouse has been restored to one of the stunning cafes in India. It offers various multi-spaces such as library, workspace and multi-brand lifestyle store.

Shopping Mall

IICC Convention & Exhibition Centre



Ambience Mall - 13.8 km from IICC

With world-class entertainment, trendsetting shopping and a variety of international standard cuisines under one roof, Ambience Mall offers high standards of quality and services.



Select Citywalk - 24.2 km from IICC

It's a modern shopping mall equipped with splendid facilities such as a square and fountain. It has continually been praised and awarded with the 'Country's Most Admired Shopping Centre' by several independent organizations.



DLF Promenade - 13.2 km from IICC

DLF Promenade is one of the most popular shopping malls in India equipped with the largest outdoor play area, cafes, and a unique open-air lifestyle space consisting of the city's largest LED screen.

Museum & Gallery

IICC Convention & Exhibition Centre



Gandhi Smriti - 21.7 km from IICC

Gandhi Smriti is an Eternal Gandhi Multimedia located in Tees January Road where Mahatma Gandhi spent the last 144 days of his life and was assassinated on 30 January 1948.



National Rail Museum - 18 km from IICC

The National Rail displays exhibits on the history of rail transport in India. In addition to its vast galleries, the museum features simulations of coaches, diesel, electric and steam engines.



Shankar's International Dolls Museum - 27.5 km from IICC

The International Dolls Museum is a large collection of dolls in Delhi, India. The collections of dolls were collected from European countries and Asian countries.

Garden & Park

IICC Convention & Exhibition Centre



TripAdvisor

Lodi Gardens – 22.8 km from IICC

Historical site, formerly known as the place for the last kingdom's tomb of Lodi, became a public park with a beautiful nature. This is now managed by the Archeological Survey of India (ASI).



TripAdvisor

Mehrauli Archaeological Park– 17.6 km from IICC

This is a Historical area spread over 200 acre in Mehrauli, adjacent to Qutub Minar World Heritage site and the Qutub complex. It consists of more than 100 historical monuments.



Thrillophilia

Nehru Park – 19.5 km from IICC

The park is one of the most famous landmarks in Delhi. It is opened in 1969 and spread over 80 acres located in the downtown. This is a regular place for art events, morning yoga classes, and houses of ancient Shiv Temple and café.

Bazaar Market/ Street Market

IICC Convention & Exhibition Centre



Dilli Haat – 19.9 km from IICC

Dilli Haat is one of the most popular bazaar markets which is managed by Delhi Tourism and Transportation Development Corporation (DTTDC). Visitors have to pay entrance fee to enter the market. Entrance fee is Adult 30 Rs/ Children 20 Rs for Indian, and 100 Rs for Foreigner. Market time is 10: 30am to 10:pm for all week.



Lajpat Nagar Central Market – 24.5 km from IICC

Lajpat Nagar is famous for India's Central street Market. Visitors can purchase high quality of garments and textiles at an affordable price.



Sarojini Nagar – 19.5 km from IICC

This is one of the largest street markets in India which is equipped with a large number of shops of international & local garments brands.

Festival

IICC Convention & Exhibition Centre



Holi Festival (All regions)

Holi festival is known as color festival which is one of the most popular festivals in India. Holi festival is organized every end of February to Mid of March to celebrate the start of spring.



Makar Sankranti – 23.5 km from IICC

This festival is also known as Kite Flying Festival in Delhi. In this festival, the entire sky is covered by different color, sizes, and shapes of kites which depicts the immense happiness and joy of the Kite festival. Makar Sankranti festival is organized in the mid of January every year.



Qutab Festival – 18.3 km from IICC

This festival is organized in the Qutab Minar, Delhi with dance, music, and lights that bring the historic structure back to life. It brings the past glory of the magnificent Qutab Minar and also depicts the cultural art performances of India. It is generally held during the months of October or November every year.